

# SEA RAIDER 42

by ALLOY



ALLOY Manufacturing Ltd.  
5350 Ferrier St.  
Montreal 309, Quebec  
735-4459

## " S E A R A I D E R 42 "

The "Sea Raider" was conceived and designed for the adventurous, luxury loving sailor. It is a self-contained, long range, all diesel and electric trawler-cruiser. Construction is of Marine Aluminum plate, with a strength ratio uncommon to boats of this size and category, which are manufactured with other materials.

This safe dependable diesel vessel features a displacement hull, 350 gallon fuel capacity (1,200 gallon optional) and a surprising cruising speed with up to a 2,500 mile range (with optional fuel capacity) for easy travel to places inaccessible to most boats.

In keeping with the concept of self-contained independence and long range luxury cruising, the "Sea Raider" is outfitted with such outstanding equipment as a 13 cubic foot no-frost refrigerator-freezer, an electric 3 burner stove with dual rotisserie oven, a stainless steel sink with hot and cold running water and more than adequate cabinet and working space. The generous 250 gallon fresh water supply provides ample water for even the longest trips. Comfortable sleeping accommodations for 6, two in the forward stateroom, two in the salon and two in the spacious aft stateroom.

The "Sea Raider" is equipped with a flying bridge featuring dual station Hynautic hydraulic steering and Panish controls with complete instrumentation. A 10 foot dinghy can be easily stored atop the cabin and launched by the working boom and mast. The design also includes a unique method for ascending to the flying bridge from the pilot house. The diesel engine(s) is mounted in the stern for easy accessibility and reduced noise. Balanced opening marine windows in the aft salon are another outstanding feature of this all weather cruiser. The insulated cabin provides individual climatization when equipped with a 16,000 B.T.U. reverse cycle air conditioner. The "Sea Raider" has shore power and shore water hookups for an added convenience.

Other luxury features of the "Sea Raider" include two complete washrooms ( 2 showers both with exhaust fans ) with a 100 gallon holding tank, a teak swim platform and ladder aft, automatic polarity controller, electrolysis monitor and safety rails.

The "Sea Raider" has proven to be a seaworthy and dependable long range cruiser equipped with every necessity and convenience to make your leisure time more relaxing and enjoyable.

All accessories described here and additional items listed in the specifications are standard equipment, not extra cost luxuries typical of most other boats. Just add your favorite electronic gear and navigation equipment and you are on your way to the relaxed type of cruising you have been dreaming about. The "Sea Raider" affords a truly unique and luxurious way to travel anywhere on water.

## STANDARD EQUIPMENT

### Hull, Deck and Superstructure

Flybridge  
Hull-1/4" welded marine aluminum plate  
Hull compartment for safety  
Superstructure and Decks - 1/8" welded marine aluminum  
Hull, sound insulated  
Thru hull stern, spring and forward cleats  
Large cockpit scuppers  
Non-skid deck surfaces  
Heavy duty all welded railings  
Flush aft deck  
All hatches self draining  
Rubber shaft bearings-positive pressure cooled  
Stainless steel shaft and rudder  
Bronze propeller - 3 blade  
Paint - multi-coated vinyl  
Antifouling T.B.T.O. bottom paint  
Interior of hull coated against condensation  
Superstructure insulated against heat and cold  
Teak swim platform with ladder  
Keel mounted anti-electrolysis anode  
All aluminum mast and boom  
Fishing cockpit  
Rope locker

### Pilot House, Forward Cabin, Aft Salon

Piloy house with dual station controls and instrumentation  
3 private staterooms  
Vee berths forward  
5" upholstered foam mattresses  
Deluxe teak panelling and moldings  
Berth lights  
Upholstered convertible L-shaped settee in pilot house  
Heavy duty windshield wiper  
Tempered safety glass  
Nylon shag carpeting throughout  
Color matched draperies  
12 - 110V overhead lights  
Ample drawers and locker storage  
Twin single beds with dresser in between in aft salon  
Stairs and door to cockpit

### Flybridge, Instruments and Pilot Controls

Command steering console  
Instrument panel  
Full engine instrumentation including:  
Recording tachometer  
Water temperature  
Ampmeter  
Oil pressure gauge  
Drive oil pressure  
Fuel gauge  
Panish throttle & clutch controls or equivalent  
Hynautic hydraulic steering system  
Adjustable helmsman's seat  
Bridge seating for eight  
Aluminum safety rails

### Galley

Electric 3-burner stove with dual rotisserie oven and hardwood cutting-board  
Decorative formica counter tops  
13 cubic foot refrigerator with freezer  
Partitioned dish and storage space  
Stainless steel sink  
Hanging shelves and ample storage space  
110 V duplex outlet for appliances  
Teakwood cabinets

### Vanity Compartments

Vitreous china wash basin with chrome fixtures  
Decorative formica lavatory tops  
Stand-up stall shower compartment  
Vinyl wall coverings  
Vanity mirror  
Portlight  
110V duplex outlet  
Vinyl floor tiles  
2 marine toilets  
2 showers with curtains  
2 exhaust blowers

### Electrical - Plumbing

Master circuit breaker and meter panel  
Wired for 110V and 12 D.C.  
12V starting system with battery selector switch  
Electric air horn  
International running lights  
Anchor light  
Cabin lights  
110V shore power split circuit with 2- 50 foot shorelines  
Automatic polarity controller  
110V fluorescent and 12V incandescent lighting  
Battery charger  
Electrolysis monitor  
Pressurized water system  
Hot water heater - 110V  
Shore water hookup  
3 wire, color coded electrical system

### Engine Compartment and Bilge

128 H.P. Ford Lehman Diesel 6 cylinder,  
Walter V-drive, freshwater cooled  
Heavy duty starting batteries  
Alternators and regulators  
Raw water intake strainers  
Sea valves on all underwater fittings  
Oil and temperature safety alarms  
Sound proof shielding surround engine and propulsion equipment  
Engine compartment blower  
1 bilge pump - automatic  
1 manual bilge pump  
Bilge water level alarm  
Light in engine compartment

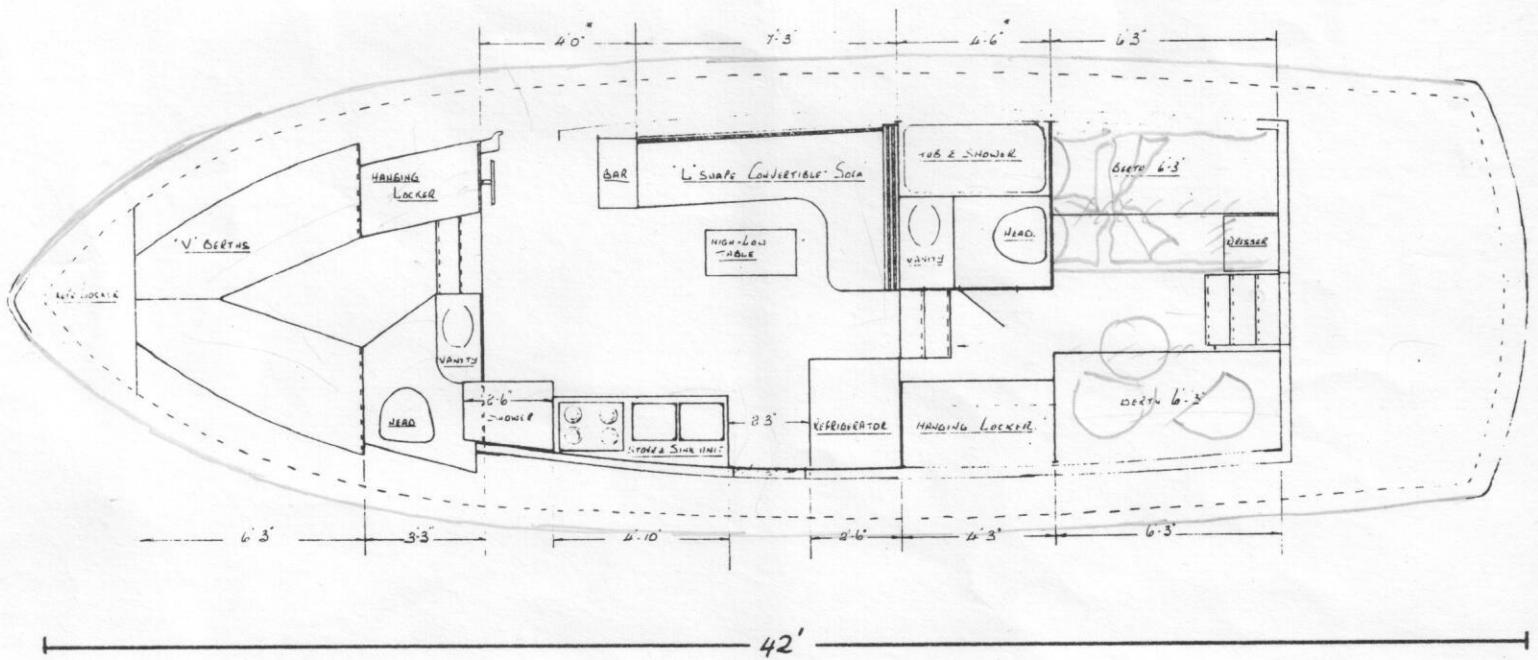

" SEA RAIDER 42 "

SPECIFICATIONS

Length overall: 42'-1"  
Beam: 13'-3"  
Draft-mean: 4'-0"  
Freeboard - forward: 7'-0"  
Transom Width: 11'-6"  
Transom Height from Waterline: 4'  
Height from Waterline to Top of Mast: 22'  
Approximate Weight: 18,000 lbs.  
Hull: 1/4" Welded Aluminum Plate  
Superstructure: 1/8" Welded Aluminum Plate  
Sleeping Accomodations: 6  
Freshwater Capacity: 250 gallons  
Fuel Capacity: 350 gallons  
Holding Tank: 100 gallons  
International Running Lights

Engine Options with Standard Equipment

Single Ford Lehman - 6 cylinders - 128 H.P. Diesel - Walter V-drive	\$60,300.
Twin Ford Lehman - 6 cylinders - 128 H.P. Diesel - Walter V-drive	\$65,800.
Single Cummins - Model 504 - 210 H.P.	\$67,265.
Single Perkins Diesel - 160 H.P.	\$64,725

Optional Equipment

1200 gallon Fuel Tanks (2) total capacity	\$ 995.
16,000 B.T.U. Crusair reverse cycle Air Conditioner- 3 outlets	\$ 1,950.
7-1/2 K.W. Diesel Generator	\$ 4,950.
Monomatic Head ( each )	\$ 435.
21 cu. ft. Refrigerator-Freezer - Ice Maker - Ice Water Dispenser	\$ 750.

1. =  
2. = 90,000  
3. =  
4. =